

## Belvedere Place, Brixton, SW2

£499,950

2 bedroom flat for sale

### Property Details

A bright and spacious two bedroom apartment, on the ground floor of an extremely popular mews development, Belvedere Place. This fantastic property is quietly tucked away at the rear of the development, and comprises a lovely, large reception and dining room, boasting a Juliet balcony with views onto the beautifully maintained communal gardens. Adjoining is a modern kitchen with ample storage, two bedrooms and two bathrooms. As far as locations go, it's hard to beat: a five-minute stroll to Brixton tube station and a ten-minute walk to Clapham High Street. Off street parking space.

### Features

- Off-street parking
- Chain free
- Shared garden
- Juliet balcony
- Close to transport links
- Secure modern development
- Walking distance to the northern and victoria tube lines

Council tax band D

EPC rating C (79)







## 2 Bed flat

Approx internal area:

**742 sqft 69 sqm**

While we do try our very best, floor plans are produced as a guide only and we take no responsibility for the precise accuracy with which any property is represented

## Belvedere Place

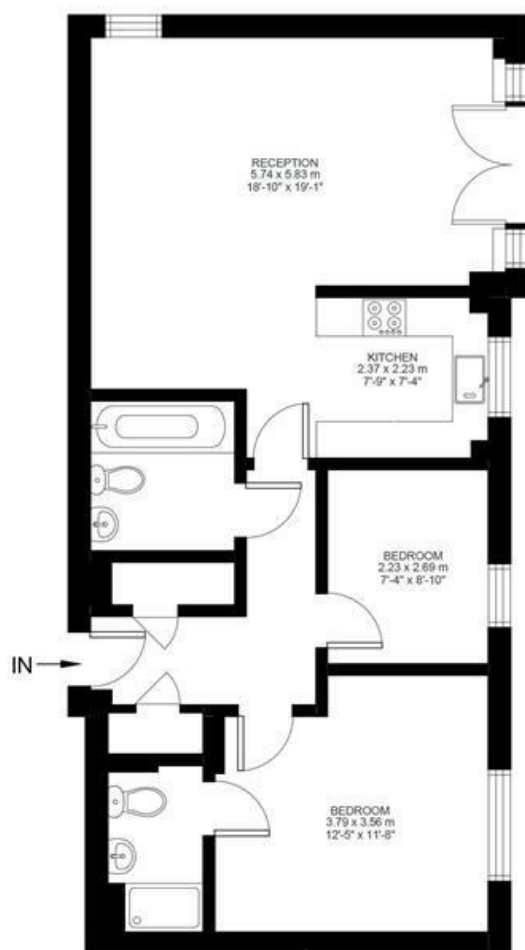

Ground Floor



Belvedere Place, Brixton, SW2

